



St Margaret's House

Bursary Studio Programme 2015



Contents

-  **2** History of St Margaret's House
-  **3** Conditions of the Bursary
-  **4** Studio Spaces Available
-  **6** Additional Resources for Bursary Students
- Dimensions of Studio Spaces Offered**
-  **7** Exhibition Spaces
-  **9** Floorplans of Studio Spaces Offered



History and Mission

St Margaret's House was set up in response to a massive demand by artists, creative businesses and community projects for affordable studio and social spaces in Scotland. Its mission has always been to contribute to the cultural diversity of the local area, providing foundation and space for artists and community arts projects and finding a viable business model to address these demands.

After searching for suitable buildings, the lease for several floors of St Margaret's House was negotiated in August 2008. The project began with 86 studio spaces being built, 71 of which were occupied. At the end of the first year, a total of 144 studios had been built, with 130 of those occupied by artists, makers or creative businesses.

By early 2010, the Edinburgh Palette charity had taken over the entirety of St Margaret's House. By then, it comprised approximately 170 working studios, over 9000 ft² of gallery space, and various community arts spaces and other facilities, including purpose-built parts of the building for photography, pottery, printmaking, theatre, yoga and martial arts.

Since 2014, the building has been operating at its full capacity. Today St Margaret's boasts over 200 studios as well as housing the Beltane Fire Society, the award-winning Edinburgh Judo Club and our resident charity, Upward Mobility. The demand and waiting list for studio space continues to grow, and the gallery spaces remain in high demand; at present, we are booking the exhibitions that will take place two years from now.

Bursary Programme

St Margaret's House offers three studio bursaries. Two are designated for current or recently-graduated art students, matriculating in both Edinburgh-based institutions and a wider area within Scotland. Those involved in the program are selected based upon merit from within the prospective art institutes and are offered studio and exhibition space, alongside additional help, guidance and access to the other facilities at St Margaret's House. **This year's programme will run from July 2015 to June 2016.** This booklet details the terms of the Bursary Programme and all that participating schools of art can expect from offering this opportunity to their students.

Conditions of Bursary Programme

Beneficiaries of the Student Bursary Scheme only pay what would normally cover the deposit for the space, rather than the true monthly rental value. Students can pay this deposit at the beginning of their tenancy, or in small monthly instalments. It safeguards the space and pays for any upkeep once they leave (repainting, cleaning, etc.).

Studios are rented to individuals with the understanding that they take care of the space and that the studios are used as a place to work to further their artistic practice, rather than as additional storage space. St Margaret's really wants to encourage the student-artists to use the space as regularly as possible, so they can feel the true value of having their own space in which to create work, whilst having the opportunity to meet and exchange ideas with all the other artists in the building.

Studios Available

Studio 5.11

This one-windowed space is ideal for students working in illustration, photography or video, and can be equipped with a desk for students to use. It is located in the west wing of the building and overlooks the railway line and Forth of Fife.

Students offered a bursary for this space are asked to pay a deposit of £120 for the year, in instalments of £11PCM. Full dimensions for the space can be found at the back of this information pack.



Illustrator Mina Braun at work in her fourth floor studio

Studio 5.19b

This two-windowed space is perfect for those who undertake larger practices such as large-scale model building, painting or sculpture. The studio is located on the east wing of the building, and overlooks the Forth of Fife.

Students offered a bursary for this space are asked to pay a deposit of £180 for the year, in instalments of £16PCM. Full dimensions for the space can be found at the back of this information pack.

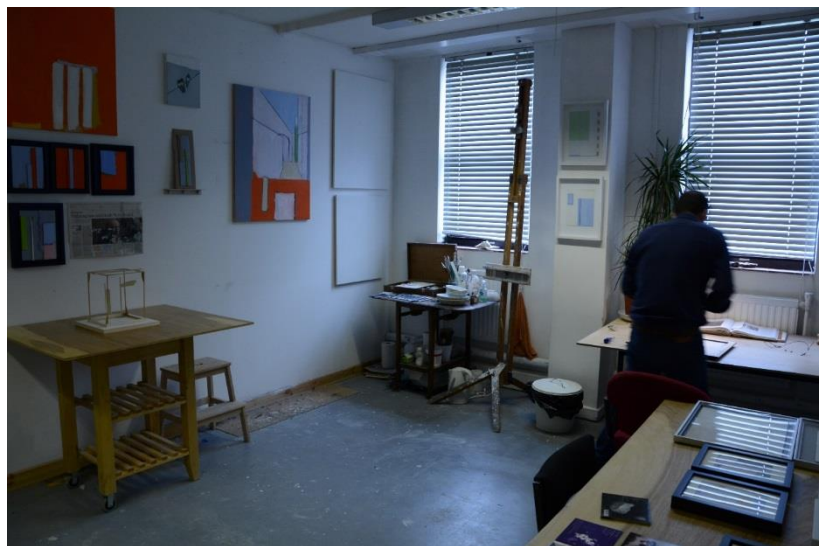

Artist at work in one of St Margaret's two-windowed studios

Studio 4.39

This three-windowed works best for artists happy to share space in which to work, or can accommodate one student who wishes to apply for a larger space to broaden their artistic practice. The latter has only happened in exceptional circumstances in the past, due to the huge demand and large waiting list for space at present. This studio is located on the east wing of the building, and is south facing, overlooking London Road.

Students offered a bursary for this space are asked to pay a deposit of £270 for the year, if sharing this is split equally between students at a rate of £13PCM, or for a single student using the space £25PCM. Full dimensions for the space can be found at the back of this information pack.



Painter Henry Fraser at work in his spacious, three-windowed room

Additional Resources

Priority Room Booking

Like any other resident of the building, students who undertake bursary slots are offered priority room booking for any of the community spaces on offer within the building. St Margaret's currently houses several community rooms, plus a health and wellbeing space, open for those who rent studios as well as external users within the community.

These spaces can be booked for classes, workshops, photography shoots and other artistic practice at a base rate of £3.00 an hour. They can be booked through contacting the office, who will put you in touch with the relevant people. Priority booking means that should the students need these spaces ahead of the public, we give them the choice of rooms and dates and times of their preference.

Library, Hotdesk and other Community Facilities

St Margaret's House has a small reference library, computer hot desk and open Wi-Fi, on the third floor gallery of the building which is available to all tenants to use. The library holds good amount of art reference books, as well as other reading materials. Each floor also has a small kitchen area for tenants to use, with the third floor housing complimentary tea and coffee facilities for our tenants and visitors.

St Margaret's House also have an in houses a Swap Shop which provides tenants with any donated furniture and other resource materials, free for all tenants. This runs like a charity shop but without donation - all items are offered for tenants to browse and take without payment.

Exhibition Space

St Margaret's House has three gallery spaces of varying size. Students who take up a studio space within the building are offered a time in which to show their work within their bursary program. Ideally held at the beginning or end of the residency, this is designed to introduce his or her work to the wider community and, in the second instance, demonstrate how the student-artist's output and process have developed and progressed during their tenure in St Margaret's.

The gallery spaces are in high demand and are booked far in advance, sometimes up to two years ahead. Previous exhibitions have included work by various collectives and solo artists who have made use of the generous space and light the galleries offer. Annually, we host an exhibition exclusively of tenants' work, showcasing the breadth of talent within the building. It is one of our most popular and well-attended events and, as tenants, bursary beneficiaries are warmly invited to take part.

Further details about the gallery spaces can be found in the St Margaret's House Gallery Info Pack.

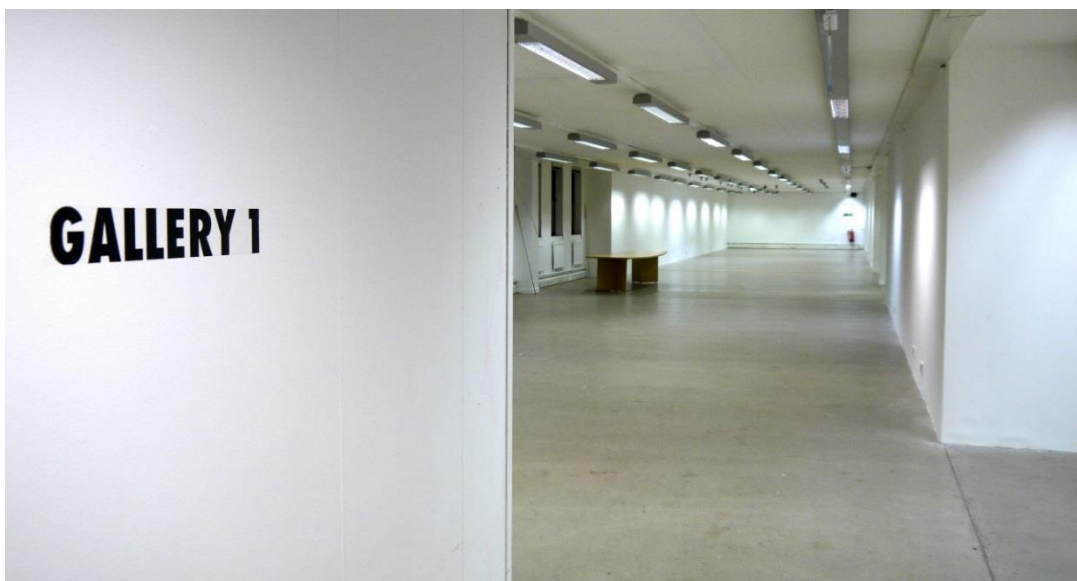

St Margaret's House Gallery 1

Networking with Other Artists

St Margaret's House is a vibrant artistic community, with over 300 artists, creative businesses and makers in residence. For students taking part in the Bursary Programme, this provides ample opportunity to meet other artists and to discuss their practice amongst our dynamic and engaging community.

Tenants are encouraged to attend the exhibitions taking place regularly in the building throughout the year, where they can meet other exhibitors and artists displaying their work. Our website also lists the regular workshops and tutorials taking place within the building and student-artists are encouraged to get involved with our community as much as possible.

We warmly welcome all of the building's present and future tenants to attend the regular, more informal social events that also take place here, as well as popping down to the library to share lunch with other tenants. Both are a great way to meet other artists within the building who make and create work within a diverse range of practices.

We have recently added some new faces to the team, whose roles are dedicated to keeping the wider art community and public informed of the work taking place within St Margaret's. Contact Daniel, Sophia or Karl in the office with any developments concerning your work and they will share this information on the centre's social media channels.



Floorplans of Studio Spaces Offered

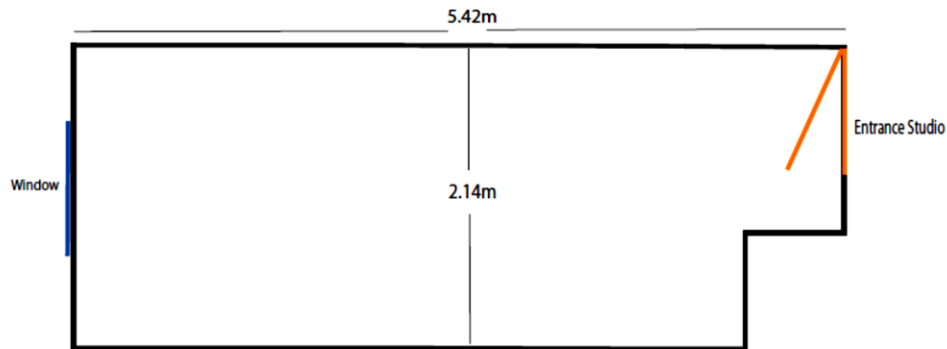

STUDIO 5.11

1 WINDOW

SINK TOILETS & FACILITIES IN MAIN CORRIDOR

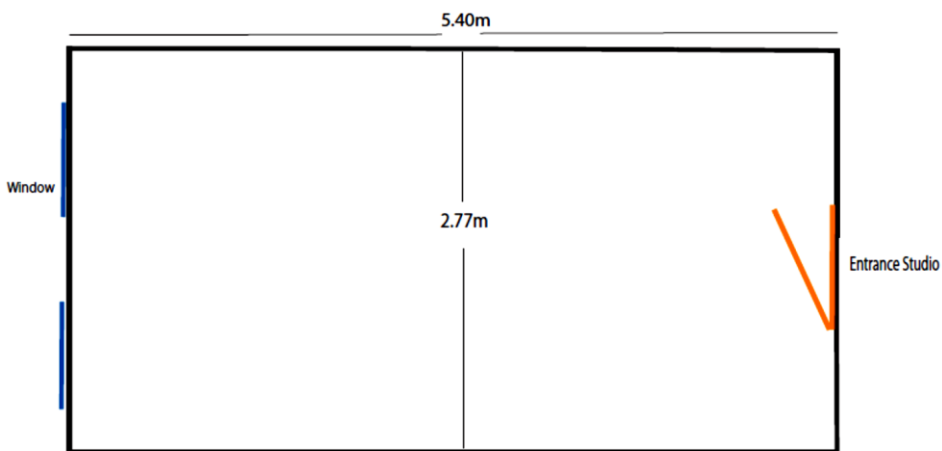

STUDIO 5.19B

2 WINDOWS

SINK TOILETS & FACILITIES IN MAIN CORRIDOR





Sophia, a long-time resident artist of the building who was recently appointed its Community Art Director, is responsible for allocating the above studios based on the nature of the student-artists' practice. She will also serve as the successful candidates' first point of contact – she has years of experience in all aspects of the art world from practicing as an artist and teaching the arts, to managing exhibitions and staging events. Her job is to ensure that the building runs smoothly each day, in conjunction with Daniel, our Building and Facilities Manager.

The office team is made up of Karl, the Community Art Assistant, and the Duty Managers, Marcin and Audra, who provide evening and weekend cover. They all have slightly different roles and areas of expertise but together are responsible for facilitating the creative environment.

Finally, all of our Trustees, two of whom hold offices in the building, are very approachable and will also be happy to talk to the student-artists about their experience and body of work during their time here.